

KLEEN BLADE

BLADE MANAGEMENT SYSTEM AND RETRACTABLE DISPOSABLE SCALPEL



The NEW KLEEN Blade Management System (BMS) compliments the existing range of safety products available from Swann-Morton in their efforts to support safe passing protocols and sharps injury reduction amongst Health Care Workers. The system which incorporates a quality Swann-Morton surgical blade is designed to operate with most standard surgical handles already in circulation within the hospital system thus minimising disruption and cost during the conversion process. The system comprises of two injection moulded parts which encapsulates a standard surgical blade and protects surgical staff from sustaining a potential sharps injury whilst attaching or removing the surgical blade from a handle.

THE NEW ALL-IN-ONE BLADE MANAGEMENT SYSTEM

- *Allows for the effortless and safe attachment of standard surgical blades*
- *Features a protective sliding sheath which covers the surgical blade completely, assisting accident free handling*
- *Sheath fully exposes the surgical blade when in use with intuitive lock which prevents any forward movement of the sheath during procedures*
- *Easy to detach BMS which contains the blade for safe disposal*
- *Sterile and ready for use*

ATTACHING THE BMS

1. The BMS system is attached to the handle B by inserting the handle into the rear of the sheath A and engaging with the slot in the blade C as is current normal practice. As with all standard blades and handles, a certain amount of care must be taken to ensure the fitment is correctly achieved; in this case however the user is completely protected from the cutting edge of the blade during the process.

2. An audible 'click' will be heard when the blade is correctly attached. Fitment can also be checked visually prior to use.

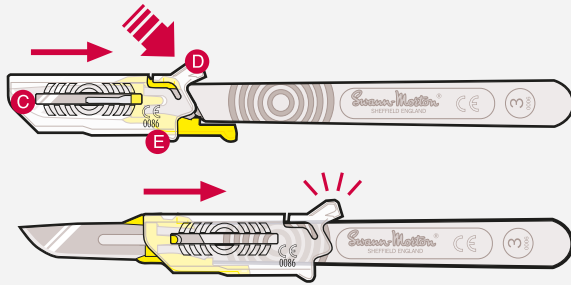
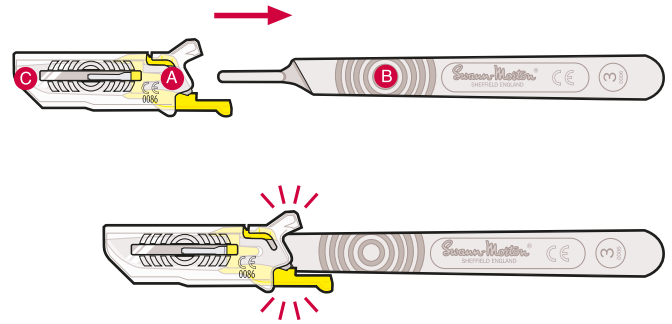

EXPOSING THE BLADE

3. To reveal the blade C, the sheath can be retracted by releasing the retaining catch D whilst simply applying pressure to the protruding rear tab E and sliding the sheath backwards.

4. A further audible 'click' will provide confirmation that the sheath A is fully retracted.

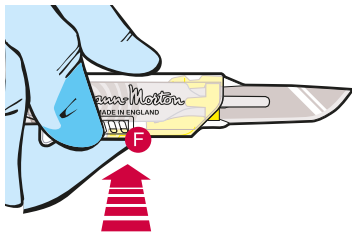

5. In this open position; surgery can now be performed in the normal manner. However during procedures where the surgeon needs to apply a little more longitudinal pressure than usual, for example when making a stab incision, the sheath can be firmly locked open by pressing lightly on the tab F in lower side area of the sheath.

CLOSING THE SHEATH & COVERING THE BLADE

6. To safely cover the blade, the sheath A can be returned to the closed position by releasing the retaining catch D in the same way as before and sliding the sheath forwards.

7. As before an audible 'click' will provide confirmation that the sheath is fully closed. This can be repeated throughout the procedure to ensure safe passing of the scalpel between members of the surgical team.

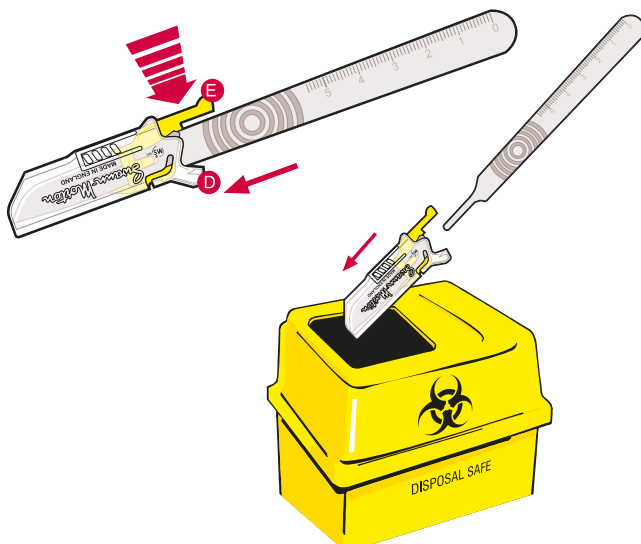
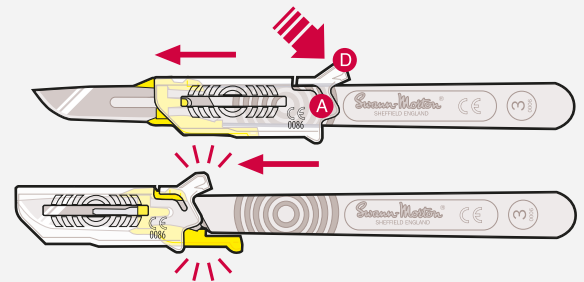

DETACHING THE BMS

8. Once the sheath is closed and on conclusion of the procedure the BMS may be safely removed from the scalpel handle. Hold scalpel in right hand with blade pointing downwards and away from your body and with the sharp edge facing to the right. With thumb on sheath clip D and forefinger on blade-removing lever E, push down and forwards simultaneously.

SHARPS DISPOSAL

9. Using firm pressure the BMS will be removed from the handle by sliding it away and can be safely disposed of, in an appropriate sharps container.